



Welcome

to the latest issue of Bolton Priestley Focus. Time seems to have caught up with us again – we barely seem to have issued the last edition of our newsletter before it's time to pull the next one together.

Long serving members of staff were saddened to hear of the death earlier this year of Derek Doel, a founding director of the firm, who assisted Chris and Paul in setting up and running Bolton Priestley in the years up to his retirement in 2001. Derek had a full and varied life as illustrated in the obituary included in this newsletter.

On a brighter note, it is Bolton Priestley's 15th anniversary this year and we pride ourselves on the repeat business we do with many clients. This issue of Focus is a celebration of our work with some of these clients since our inception and includes our refurbishment work for St Mungo's Community Housing Association and their prestigious new-build hostel in Brent; Haberdashers' Aske's School for Girls where the design of a new teaching block was our 6th project with the school; glass, stainless steel & aluminium structures with Dane Architectural Systems Limited; and our London hotels portfolio. From the healthcare sector there are articles on our work for BUPA & Spire Healthcare along with our extensive portfolio of secure mental health units for Partnerships in Care.

Finally, Chris, Paul and myself wish you all the very best in the coming months and years and trust we all survive to prosper in the future. We have recently seen an upturn in our workload and hope this is the sign of things to come and not the dreaded "double dip!"

Remember, if Bolton Priestley can be of assistance we are only a phone call, e-mail, or even fax, away!!

Geoff Othick

Haberdashers' Aske's School for Girls

Chris first worked with architects Initiatives In Design on a new Arts and Music block for the school in 1993. This formed the first phase of the school's redevelopment masterplan to enhance and replace the original 1970s structure. Since the formation of Bolton Priestley in 1995, we have been involved in all phases of the redevelopment.

The first major proposed improvement was the development of a new teaching and lecture theatre in the area of the existing boiler house and gymnasium. A new more discrete boiler house was built on another part of the site in 1998 along with a new gymnasium, freeing up the land for the new lecture theatre to be built in 2000. In 2003 came an enlarged replacement junior school, with circulation space to other existing blocks. As the school had gained a reputation for winning national championships for synchronized swimming, a new 25m swimming pool with spectator area was designed to link into the new gym building so that sporting facilities were all housed in one area. This was opened in 2008.

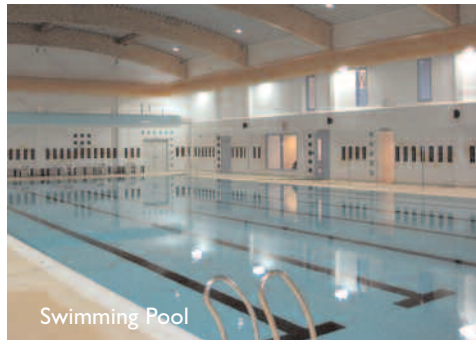

Swimming Pool



Arts and Music Block

A new three-storey administration block was completed in 2010 and our work at the school continues with a feasibility study for mezzanine space in the 1995 Arts and Music block.

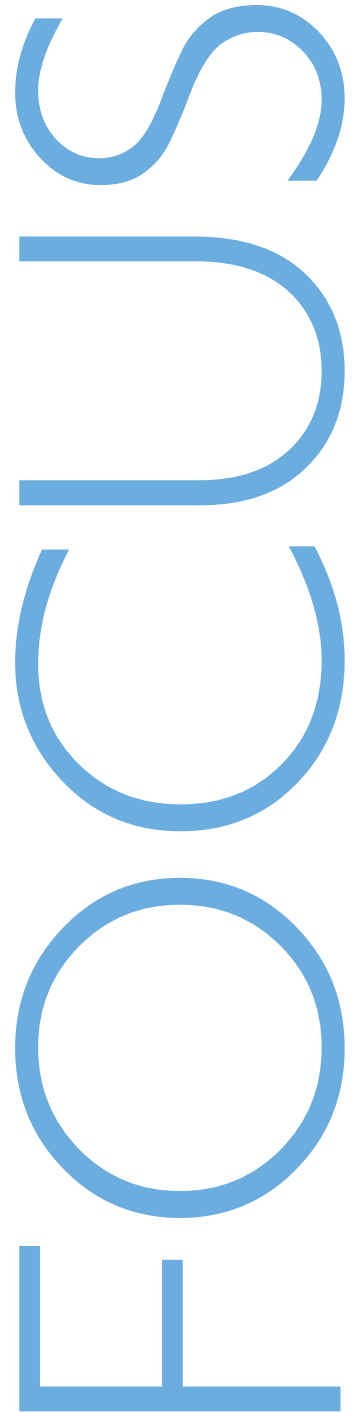
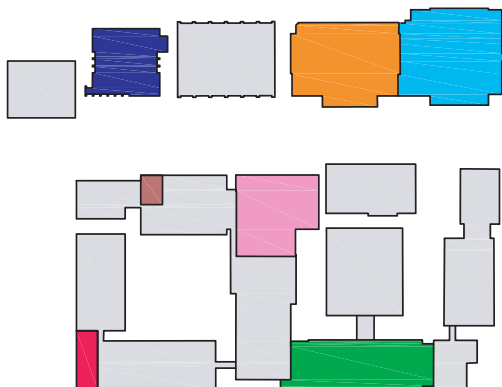

St Mungo's Housing Association

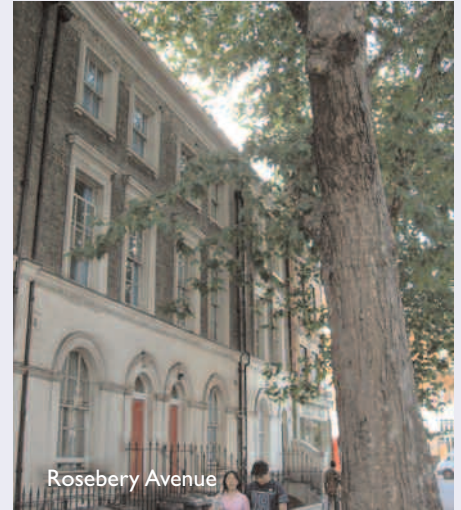

St Mungo's Community Housing Association Limited is London's largest charity aimed at assisting homeless people. Since 2005 we have developed an excellent relationship with St Mungo's project managers, working on many refurbishments and significant extensions of hostels of varying sizes.

One of the first, in 2005, was a relatively small lightweight vertical extension of the St Pancras Way Hostel, involving the justification of the existing foundation to carry the increased loads. In 2007 the Rosebery Avenue project required major structural refurbishment to increase room sizes to modern standards. Later at Endell Street, in the heart of the West End, a former Grade II listed London Board school building was transformed into an award winning multi-use hostel. Peter Barber Architects utilised many of the exposed original features as part of the final design, resulting in a scheme that delighted both St Mungo's and English Heritage.

The Mare Street Hostel was a major refurbishment of a former police station and

improvements included the removal of part of the ground floor to create a double height leisure area, plus new medical centre with a steel framed mezzanine floor. Both hostels were completed in 2008. The Francis Street Hostel in Victoria underwent structural refurbishment in which bedrooms were enlarged and improved facilities provided.

In our Autumn 2009 Focus publication we reported on our involvement in St Mungo's landmark project at Pound Lane, Brent, which is now complete and looking very stunning; detail

design was undertaken by Buller Greenbury Associates and constructed by Quinn London. This flagship new-build hostel provides 83 bedrooms and brings together services for homeless people and the community.

We are pleased to report that Bolton Priestley continues to assist St Mungo's on several ongoing schemes and we hope to continue our excellent working relationship with this worthwhile charity for many years to come.

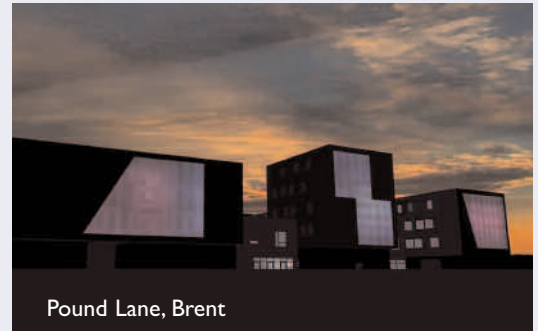

BUPA / Spire Hospitals

Chris Priestley and Paul Bolton have been involved with BUPA since they embarked on a rapid hospital building programme in the early 1980s, designing the new Harpenden Hospital, followed by another at Norwich. Soon after they were involved in the major re-developments of BUPA Portsmouth hospital, followed by further extensions at Norwich, Harpenden and Murrayfield Hospital on the Wirral.

When Paul and Chris redeployed their services to an Anglo/Irish consultancy in the 90s they were fortunate to be able to continue to assist on BUPA capital projects at Wellesley and Bushey, providing structural and civil engineering services to create new bedroom blocks at both hospitals. After the formation of Bolton Priestley in 1995, BUPA continued to utilise our services; we like to think that this is

because we provide a reliable, honest and thoughtful service and we are very grateful for their continued loyalty.

Spire Hospitals took over many of the BUPA Group hospitals in 2007, however we are still working with BUPA, providing advice on their new Call Centre in Staines along with the Wellness Centre in the west end of London. We are pleased to be now working for both BUPA and Spire Hospitals. Recently we have been commissioned on several projects for Spire, taking us back to the former BUPA hospitals, such as Bushey where we have been involved in the refurbishment to add a new theatre, along with X-Ray facilities, CT suite, OPD ward and increased car parking. Smaller projects include refurbishments at Wellesley, Murrayfield, Thames Valley and Liverpool.



Derek Alfred Doel

1926 to 2010

BSc(Eng), BEc, CEng, FIMechE, FRAeS



Former colleagues were recently saddened to hear of the death of Derek Doel, a founder member of the company. As Financial Director from 1995 to 2001, Derek was responsible for company finances in the early days of Bolton Priestley, his knowledge and experience enabling Paul and Chris, his son-in-law, to focus on providing a thorough engineering service to clients.

Derek's career began when he obtained a degree in Engineering at Regent Street Polytechnic, London. This was followed by conscription for two years into the army as an officer in the Royal Electrical & Mechanical Engineers. In 1948 he was posted to the Royal Military College of Science in Wiltshire to lecture in Engineering after which he joined English Electric based at Luton Airport. Derek remained with this company as it evolved and finally changed name to British Aerospace where he became an Executive Director. He retired from this post in 1986 to form his own company, Milidyne Associates. Chris and Paul's association with this firm later lead on to the development of Bolton Priestley in 1995, when they decided to combine their complimentary skills and 15 years of joint working experience to form their own structural engineering company.

A keen sportsman Derek excelled at many sports including surfing, rifle shooting, swimming and golf, latterly becoming a very active member at Letchworth Golf Club.

London Hotels

Situated North of Hyde Park, the Lancaster London Hotel is built over and around the Lancaster Gate Underground Station. Chris Priestley first worked on the property in 1989 with John Sisk and Sons, when the hotel was owned by Rank Hotels. Bolton Priestley was established in 1995 and soon after the Hotel asked us to manage an extensive programme of investigations and repairs of the pre-cast concrete cladding panels that form the hotel façade.

In 1998 the hotel put forward a proposal to redevelop the public amenity space, extend the restaurants and provide extended meeting, conference and break out space as part of an £11M scheme, with Bolton Priestley providing full structural engineering services. The structural scheme formulated was based on a steel frame with composite concrete floors

designed so that key service routes would pass through the shallow beams. Foundations were piled with depths to avoid surcharge to the adjacent London Underground tube tunnels.

The new owner subsequently purchased The London Landmark and K West Hotel & Spa and we advised on the conditions survey of the building structure, fabric and M&E installations as part of the pre-purchase activities. Over the past 5 years we have worked on all three hotels, dealing with a wide range of conversions and redevelopments and in 2007 managed the further façade maintenance works and recoating of the Lancaster London. Our 24 year involvement with the hotel group continues with projects currently underway at two of the hotels and a recently completed at the other.



Landmark London Ballroom



Lancaster London

Partnerships in Care

Over the last 15 years, Bolton Priestley has developed strong links with Partnerships in Care, the largest independent provider of secure mental health facilities across the UK. We have provided structural and civil engineering advice, including drainage design, on several of their refurbishment and new build projects ranging from minor refurbishment to £110m new build psychiatric hospitals.



Calverton Hill

We work within a design team headed by Holden & Lee (Project Manager) who also provide QS services, with Gilling Dodd architects and JRB Environmental M&E engineers. Partnerships in Care maintain a hands-on approach throughout the design and construction process to ensure that they deliver state-of-the-art facilities to provide the best possible care for their patients and to help prepare them for return to community services or alternative residential accommodation.



Calverton Hill roof detail

design of a new 42-bed ward block at their Kneesworth House site in Hertfordshire and there are, hopefully, further schemes in the pipeline.

Our largest schemes (to date) have been the new 64-bed Calverton Hill, Nottinghamshire hospital and the 74-bed medium secure hospital at Arbury Court, Warrington which also incorporates Partnerships in Care's National Training Centre. We are currently embarking on the

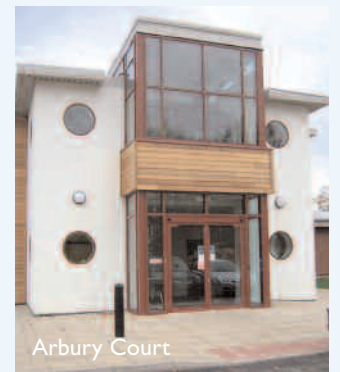

Arbury Court



Kemple View

Dane Architectural Systems Ltd

Dane Architectural Systems Ltd. is one of the country's leading curtain wall and specialist architectural metalwork contractors, based just outside Newcastle. Our Selby office has provided structural advice to them, particularly the metalwork division, over many years. The type of work includes staircases, canopies, balconies, balustrades, cladding, crowd barriers etc., giving us the opportunity to develop our expertise in glass, stainless steel and aluminium design. Whilst at first glance these elements may appear to have little structural input, they can often be quite complex as they are the bits that people see and architects like to use them to provide interesting features.



Urbis, Manchester



DSS Longbenton

Our portfolio with Dane includes work on many of the UK's major new buildings including:

City of Manchester Stadium
New Hampden Park
Calderdale Royal Hospital, Halifax
Freeman Hospital, Newcastle
Manchester Airport
Doncaster 'Robin Hood' Airport
DSS Offices, Longbenton, Newcastle
BBC Media Centre, Manchester
The Sage, Gateshead
Urbis, Manchester
Scottish Parliament
Arndale Centre, Manchester
Metrocentre, Gateshead
The Trafford Centre, Manchester
Ocean Terminal, Edinburgh
RBS World Headquarters, Edinburgh
Deutsche Bank, Edinburgh
Northumbria University
Keyworth Centre, LSBU
2012 Athletes Village

We are currently working with them on several staircases, balustrades and balconies at the new Business School for Manchester Metropolitan University; balcony balustrades for the Athletes' Village for the 2012 Olympics and roof walkway gantries (over 1km length) in the National Indoor Sports Arena & Velodrome for the 2014 Glasgow Commonwealth Games.



RVI, Newcastle



Scottish Parliament



Glasgow Fort



Northumbria University

News in brief

Bolton Priestley are providing structural engineering services as part of the architect (Initiatives in Design) lead design team for the new £7.5M Alderman's Green Primary School, Coventry. The team was in competition with 40 other consortia and was awarded the contract in May of this year. Wates Construction is the preferred contractor with start on site due in spring 2011.

Following stage E status and contractor selection in early 2009, the £6M residential project in Islamabad featured in our Spring 2009 Focus finally achieved funding approval for a reduced scheme earlier this year. Works commence on site in October and Chris and Geoff are likely to be making visits to site every 2 months. The 4 storey scheme is designed to seismic requirements complying with local and Eurocode standards.

Over the past 12 months Anna and Chris have had a busy time training and travelling the world representing GBR in Age group multisport events. In May Anna won a bronze medal in the European Duathlon championships in Nancy, France. In September 2009 Chris came 3rd Brit in world Duathlon championships in Concord NC USA. In July they both travelled to Athlone, Ireland for the European Triathlon Championships where Anna came 3rd Brit and both have recently returned from Edinburgh where they competed in world Duathlon championships 2010 based around the challenging setting of Hollyrood Park.

Bolton Priestley is pleased to announce our continued relationship with Sir William Perkins's Independent School; Initiatives in Design architects have gained planning approval for a 10 year master plan to improve and expand the facilities at the school in Chertsey, Surrey. Tender documents for Phase I have been issued for the new sports hall changing rooms, dance studio, PE classroom and rowing studio.

We have recently completed the Music Block at The Tiffin Girls School. This is a well sort after state school whose academic results placed them 5th in the national league table. Bolton Priestley would like to confirm our best wishes to the recently retired Head Teacher, Pauline Cox and wish Vanessa Ward, the new Head Teacher the best of fortune, particularly during this period of financial restraint.

Bolton Priestley has been fortunate to assist the Lancaster London Hotel in the remodelling of their two main kitchens, involving major works whilst continuing the operation of the Hotel. The Westbourne Kitchen is now complete and we have now commenced design of the Nine Kings Kitchen. Along with other significant improvements in the pipeline, this is all part of the Hotel's drive to ensure that it remains one the most prestigious hotels in London.

We have recently been appointed by Red Rose Dry Lining to provide structural advice for their new children's nursery & swimming pool in Buckshaw Village, Chorley. This will be their second 'early years' venture following on from a successful development in Darwen which they continue to own and operate. We were introduced to Red Rose by the project architect, Stanton Andrews, with whom we have worked since their formation in 2006.

Hampstead Lodge
77 Bell Street

LONDON NW1 6TA

T. 020 7724 0226 F. 020 7224 9588

london@boltonpriestley.co.uk

27 Ousegate Business Centre

Ousegate **SELBY**

North Yorkshire YO8 4NN

T. 01757 212122 F. 01757 213509

selby@boltonpriestley.co.uk

The Nursery House

62 Baldock Road

LETCHEWORTH GARDEN CITY

Hertfordshire SG6 2EE (Registered office)

T. 01462 674636 F. 01462 628295

letchworth@boltonpriestley.co.uk

www.boltonpriestley.co.uk